

虎门镇南栅现代化产业园片区7号传统产业类“三旧”改造单元房屋权籍调查权属分布图

2521.900-38469.100

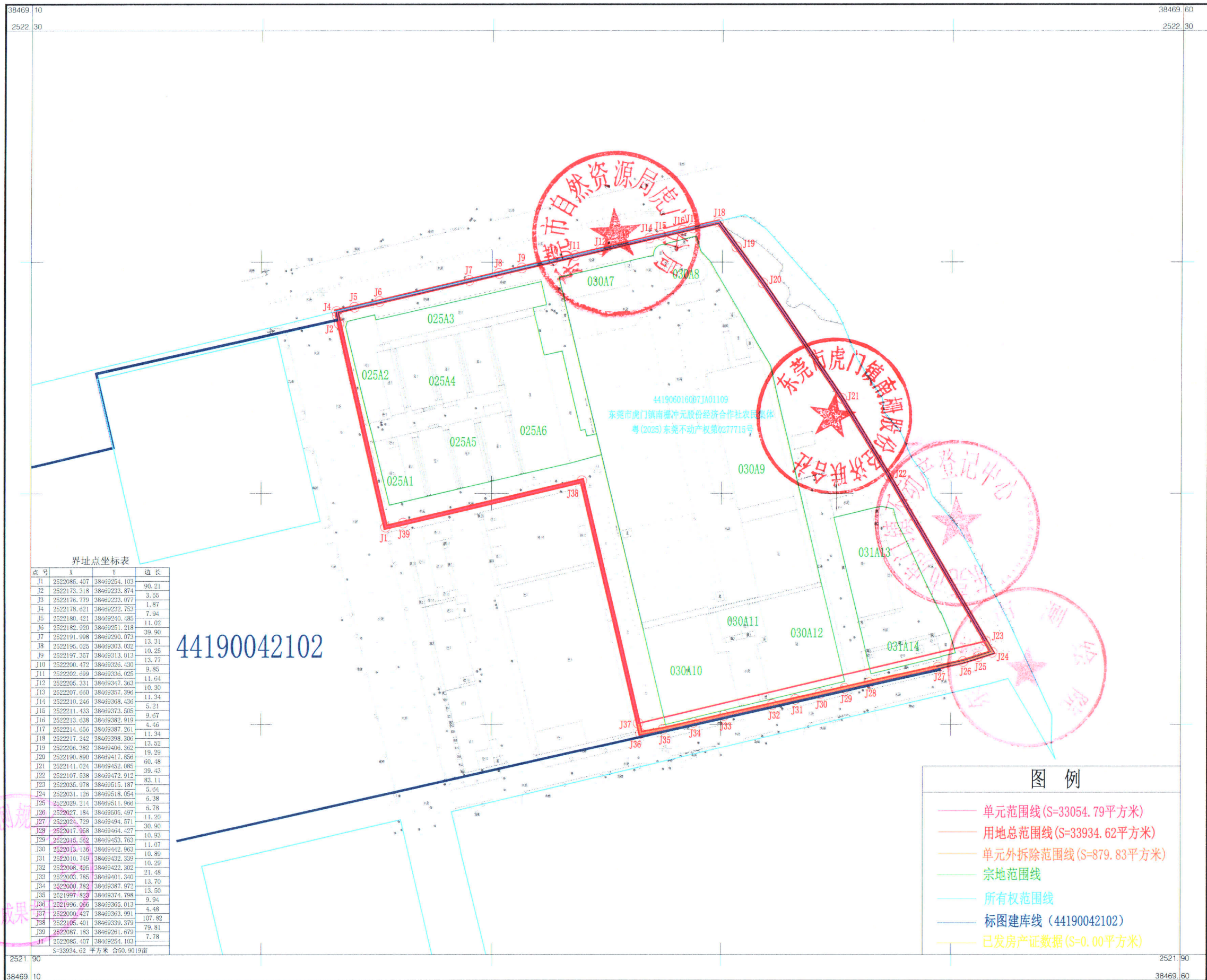

界址点坐标表

点号	X	Y	边长
J1	2522085.407	38469254.103	90.21
J2	2522173.318	38469233.874	3.56
J3	2522176.779	38469233.077	1.87
J4	2522178.621	38469232.753	7.94
J5	2522180.421	38469240.485	11.02
J6	2522182.920	38469251.218	39.90
J7	2522191.998	38469290.073	13.31
J8	2522196.025	38469303.032	10.25
J9	2522197.357	38469313.013	13.77
J10	2522200.472	38469326.430	9.85
J11	2522202.699	38469336.025	11.64
J12	2522205.331	38469347.363	10.30
J13	2522207.660	38469357.396	11.34
J14	2522210.246	38469368.436	5.21
J15	2522211.433	38469373.505	9.67
J16	2522213.638	38469382.919	4.46
J17	2522214.656	38469387.261	11.34
J18	2522217.242	38469398.306	13.52
J19	2522206.382	38469406.362	19.29
J20	2522190.890	38469417.850	60.48
J21	2522141.024	38469452.085	39.43
J22	2522107.538	38469472.912	83.11
J23	2522035.978	38469515.187	5.64
J24	2522031.126	38469518.054	6.38
J25	2522029.214	38469511.966	6.78
J26	2522027.184	38469505.497	11.20
J27	2522024.729	38469494.571	30.90
J28	2522017.958	38469464.427	10.93
J29	2522015.562	38469453.763	11.07
J30	2522013.136	38469442.963	10.89
J31	2522010.749	38469432.339	10.29
J32	2522008.495	38469422.302	21.48
J33	2522003.785	38469401.340	13.70
J34	2522000.782	38469387.972	13.50
J35	2521997.823	38469374.798	9.94
J36	2521996.056	38469365.013	4.48
J37	2522000.427	38469363.991	107.82
J38	2522105.401	38469339.379	79.81
J39	2522087.183	38469261.679	7.78
J4	2522085.407	38469254.103	

广东广量勘测规划有限公司

2000国家大地坐标系,1985国家高程基准,等高距为0.5米
GB/T20257.1-2017国家基本比例尺地图图式 第1部分
1:500 1:1000 1:2000地形图图式
GB/T42547-2023地籍调查规程
2026年03月数字化测图

1:1000

附注:测量员:冯智佳
绘图员:林锐萍
审核员:郝印选