

东莞市万江街道龙湾滨江片区连片更新单元坝新苑改造项目 土地和房屋权属调查权属分布图
2547.5-38471.4

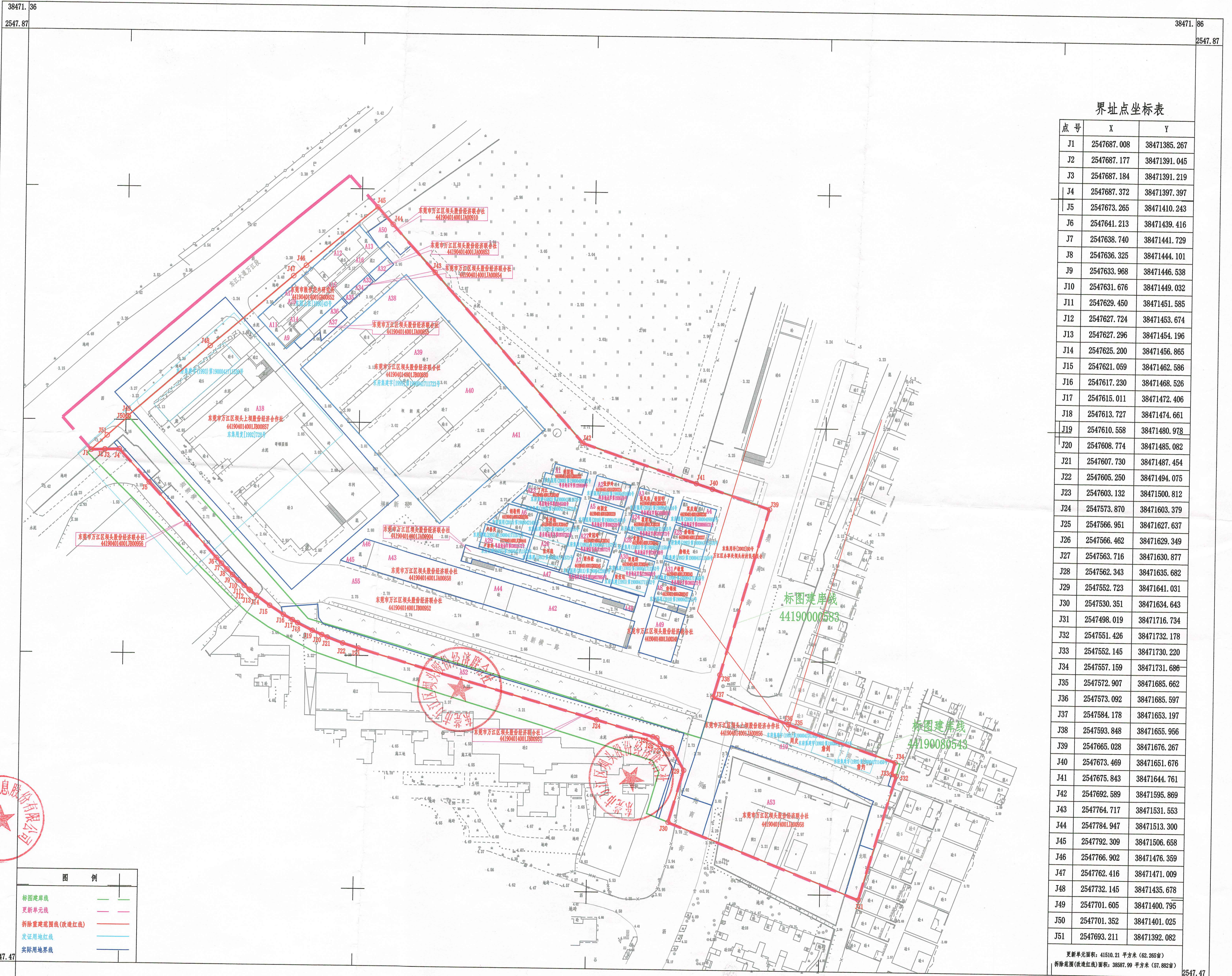
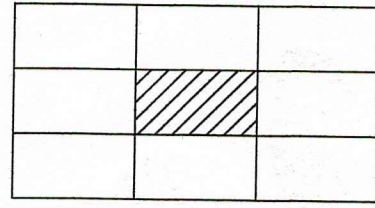

界址点坐标表

点号	X	Y
J1	2547687.008	38471385.267
J2	2547687.177	38471391.045
J3	2547687.184	38471391.219
J4	2547687.372	38471397.397
J5	2547673.265	38471410.243
J6	2547641.213	38471439.416
J7	2547638.740	38471441.729
J8	2547636.325	38471444.101
J9	2547633.968	38471446.538
J10	2547631.676	38471449.032
J11	2547629.450	38471451.585
J12	2547627.724	38471454.674
J13	2547627.296	38471454.196
J14	2547625.200	38471456.865
J15	2547621.059	38471462.586
J16	2547617.230	38471468.526
J17	2547615.011	38471472.406
J18	2547613.727	38471474.661
J19	2547610.558	38471480.978
J20	2547608.774	38471485.082
J21	2547607.730	38471487.454
J22	2547605.250	38471494.075
J23	2547603.132	38471500.812
J24	2547573.870	38471603.379
J25	2547566.951	38471627.637
J26	2547566.462	38471629.349
J27	2547563.716	38471630.877
J28	2547562.343	38471635.682
J29	2547552.723	38471641.031
J30	2547530.351	38471634.643
J31	2547498.019	38471716.734
J32	2547551.426	38471732.178
J33	2547552.145	38471730.220
J34	2547587.159	38471731.686
J35	2547572.907	38471685.662
J36	2547573.092	38471685.597
J37	2547584.178	38471653.197
J38	2547593.848	38471655.956
J39	2547665.028	38471676.267
J40	2547673.469	38471651.676
J41	2547675.843	38471644.761
J42	2547692.589	38471595.869
J43	2547764.717	38471531.553
J44	2547784.947	38471513.300
J45	2547792.309	38471506.658
J46	2547766.902	38471476.359
J47	2547762.416	38471471.009
J48	2547732.145	38471435.678
J49	2547701.605	38471400.795
J50	2547701.352	38471401.025
J51	2547693.211	38471392.082

更新单元面积: 41510.21 平方米 (62.265亩)
拆除范围(改造红线)面积: 38587.99 平方米 (57.882亩)

广东中冶地理信息股份有限公司

图例	
标图建库线	——
更新单元线	——
拆除范围(改造红线)	——
发证用地红线	——
实际用地界线	——

2000国家大地坐标系, 1985国家高程基准, 等高距为0.5米
GB/T20257.1-2007国家基本比例尺地图图式
1:500地形图图式
2020年11月全野外数字化测图

1:1000

测量员: 李岳鸿
绘图员: 付英
审核员: 李战