

| | | |
|---------------------|---------------------|---------------------|
| 2549.199-2549.199 | 2549.199-2549.199 | 2549.199-2549.199 |
| 38453.152-38453.152 | 38453.900-38453.900 | 38454.648-38454.648 |
| 2548.742-2548.742 | 38453.152-38453.152 | 2548.742-2548.742 |
| 38453.152-38453.152 | 2548.285-2548.285 | 38454.648-38454.648 |
| 2548.285-2548.285 | 38453.152-38453.152 | 2548.285-2548.285 |
| 38453.152-38453.152 | 38453.900-38453.900 | 38454.648-38454.648 |

东莞市麻涌镇人民政府

2548.742-38453.900

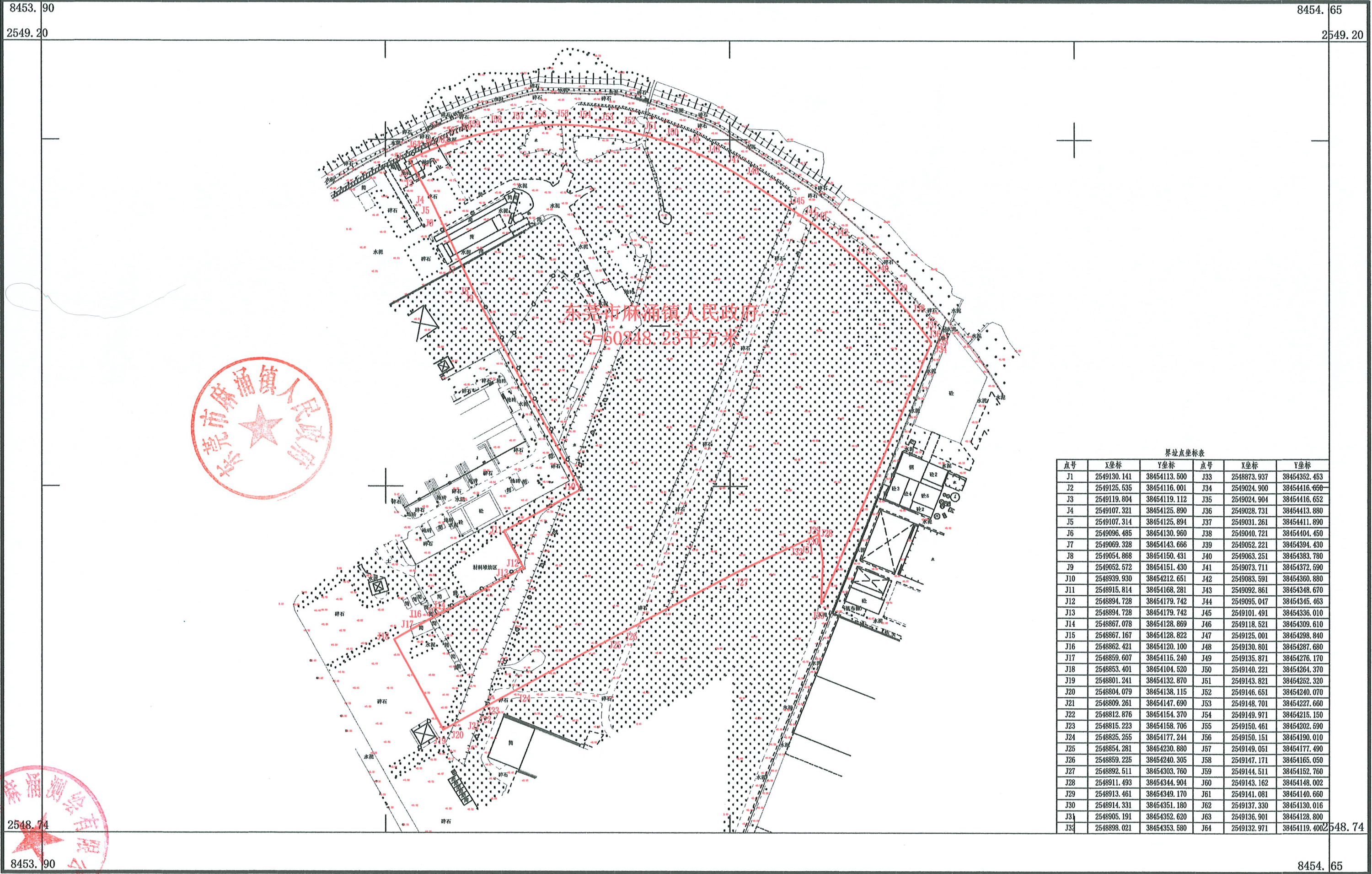

东莞市麻涌测绘有限公司

界址点坐标表

| 点号 | X坐标 | Y坐标 | 点号 | X坐标 | Y坐标 |
|-----|-------------|--------------|-----|-------------|--------------|
| J1 | 2549130.141 | 38454113.500 | J33 | 2548873.937 | 38454352.453 |
| J2 | 2549125.535 | 38454116.001 | J34 | 2549024.900 | 38454416.656 |
| J3 | 2549119.804 | 38454119.112 | J35 | 2549024.904 | 38454416.652 |
| J4 | 2549107.321 | 38454125.890 | J36 | 2549028.731 | 38454413.880 |
| J5 | 2549107.314 | 38454125.894 | J37 | 2549031.261 | 38454411.890 |
| J6 | 2549096.485 | 38454130.960 | J38 | 2549040.721 | 38454404.450 |
| J7 | 2549069.328 | 38454143.666 | J39 | 2549052.221 | 38454394.430 |
| J8 | 2549054.868 | 38454150.431 | J40 | 2549063.251 | 38454383.780 |
| J9 | 2549052.572 | 38454151.430 | J41 | 2549073.711 | 38454372.590 |
| J10 | 2548939.930 | 38454212.651 | J42 | 2549083.591 | 38454360.880 |
| J11 | 2548915.814 | 38454168.281 | J43 | 2549092.861 | 38454348.670 |
| J12 | 2548894.728 | 38454179.742 | J44 | 2549095.047 | 38454345.463 |
| J13 | 2548894.728 | 38454179.742 | J45 | 2549101.491 | 38454336.010 |
| J14 | 2548867.078 | 38454128.869 | J46 | 2549118.521 | 38454309.610 |
| J15 | 2548867.167 | 38454128.822 | J47 | 2549125.001 | 38454298.840 |
| J16 | 2548862.421 | 38454120.100 | J48 | 2549130.801 | 38454287.680 |
| J17 | 2548859.607 | 38454115.240 | J49 | 2549135.871 | 38454276.170 |
| J18 | 2548853.401 | 38454104.520 | J50 | 2549140.221 | 38454264.370 |
| J19 | 2548801.241 | 38454132.870 | J51 | 2549143.821 | 38454252.320 |
| J20 | 2548804.079 | 38454138.115 | J52 | 2549146.651 | 38454240.070 |
| J21 | 2548809.261 | 38454147.690 | J53 | 2549148.701 | 38454227.660 |
| J22 | 2548812.876 | 38454154.370 | J54 | 2549149.971 | 38454215.150 |
| J23 | 2548815.223 | 38454158.706 | J55 | 2549150.461 | 38454202.590 |
| J24 | 2548825.265 | 38454177.244 | J56 | 2549150.151 | 38454190.010 |
| J25 | 2548854.281 | 38454230.880 | J57 | 2549149.051 | 38454177.490 |
| J26 | 2548859.225 | 38454240.305 | J58 | 2549147.171 | 38454165.050 |
| J27 | 2548892.511 | 38454303.760 | J59 | 2549144.511 | 38454152.760 |
| J28 | 2548911.493 | 38454344.904 | J60 | 2549143.162 | 38454148.002 |
| J29 | 2548913.461 | 38454349.170 | J61 | 2549141.081 | 38454140.660 |
| J30 | 2548914.331 | 38454351.180 | J62 | 2549137.330 | 38454130.016 |
| J31 | 2548905.191 | 38454352.620 | J63 | 2549136.901 | 38454128.800 |
| J32 | 2548898.021 | 38454353.580 | J64 | 2549132.971 | 38454119.400 |

2000国家大地坐标系, 1985国家高程基准, 选高距为0.5米
 GB/T20257.1-2017国家基本比例尺地形图图式 第1部分:
 1:500 1:1000 1:2000地形图图式
 2024年7月测制。

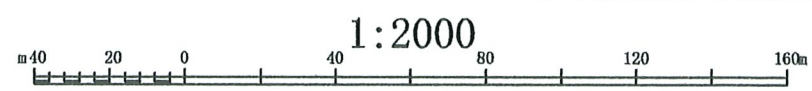

附注:

测量员: 袁中冠
 制图员: 萧应年
 审核员: 陈超毅